

Alameda 01

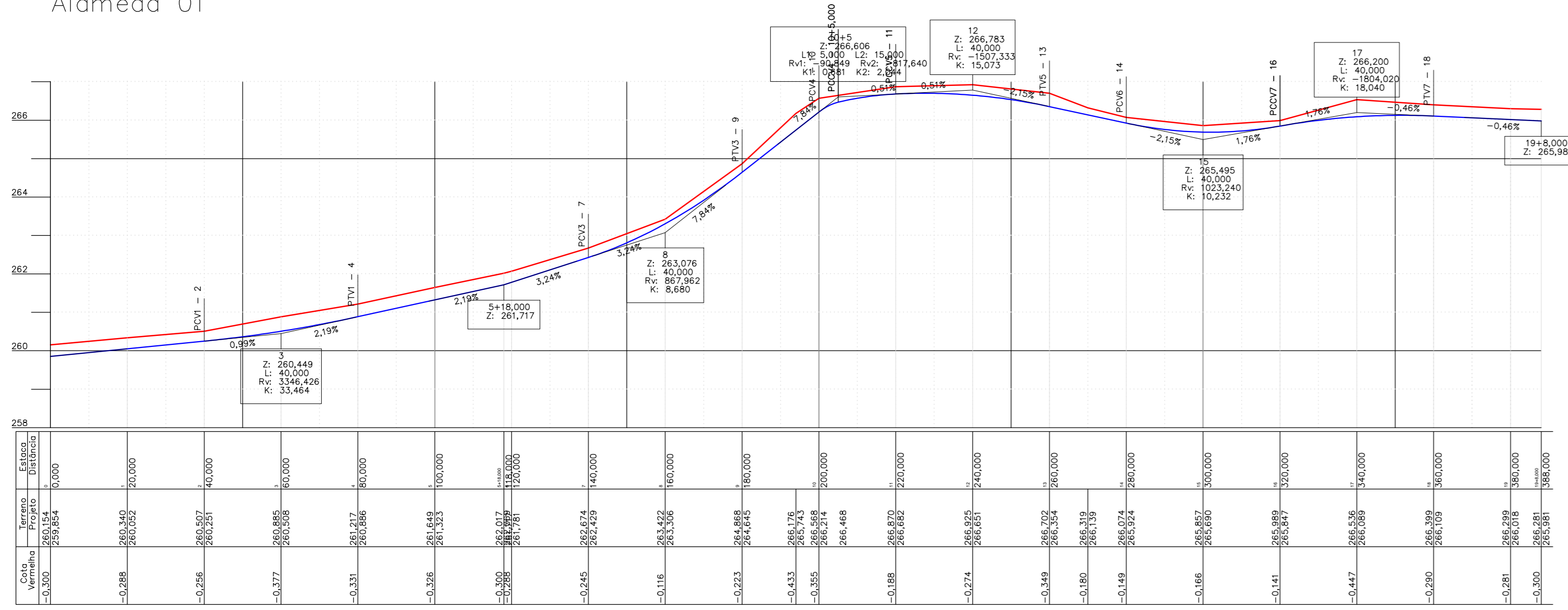

Alameda 02

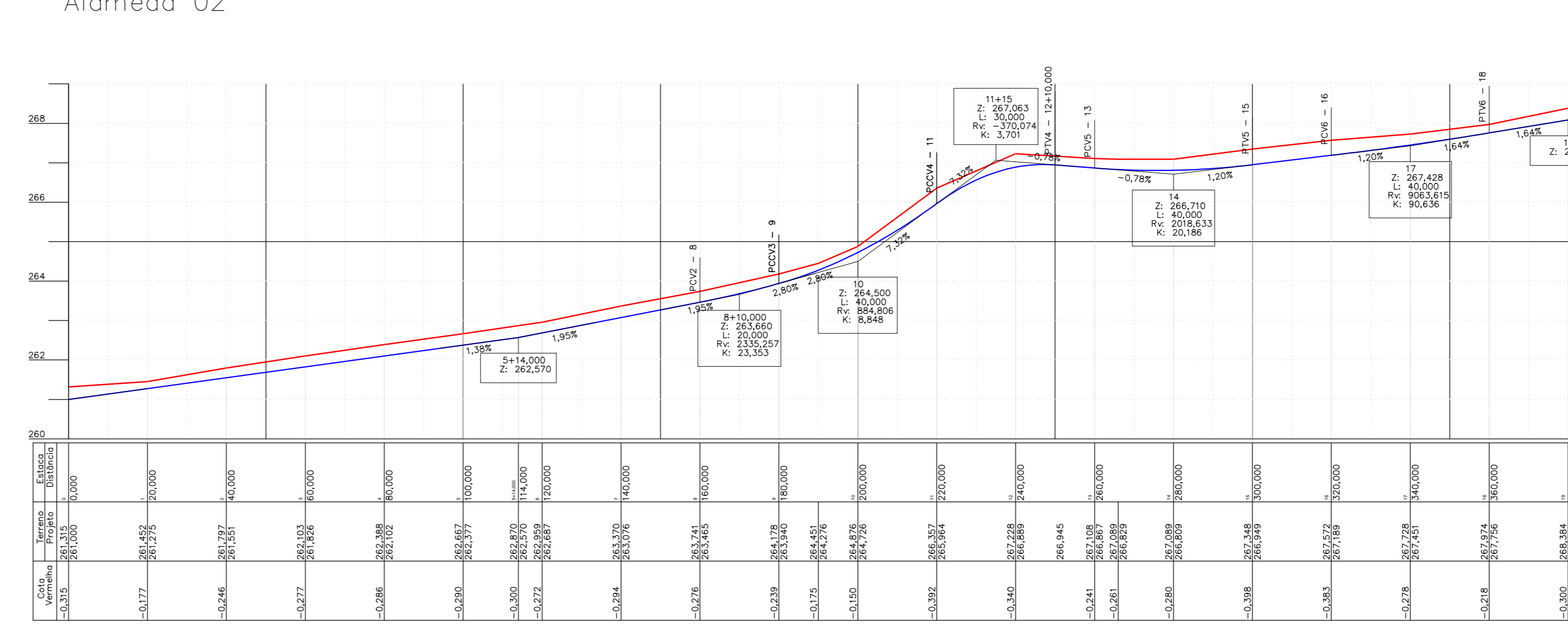

Alameda 03

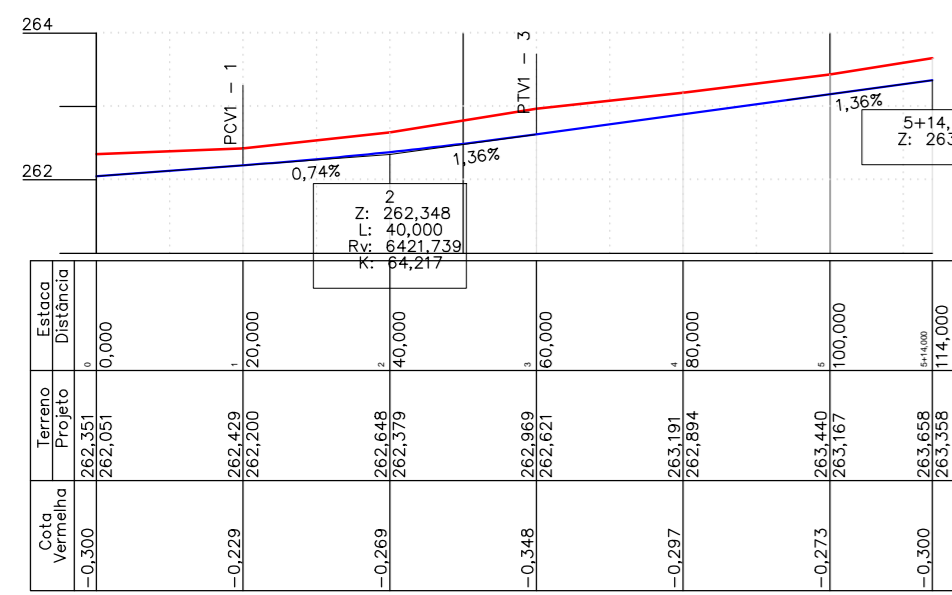

Alameda 04

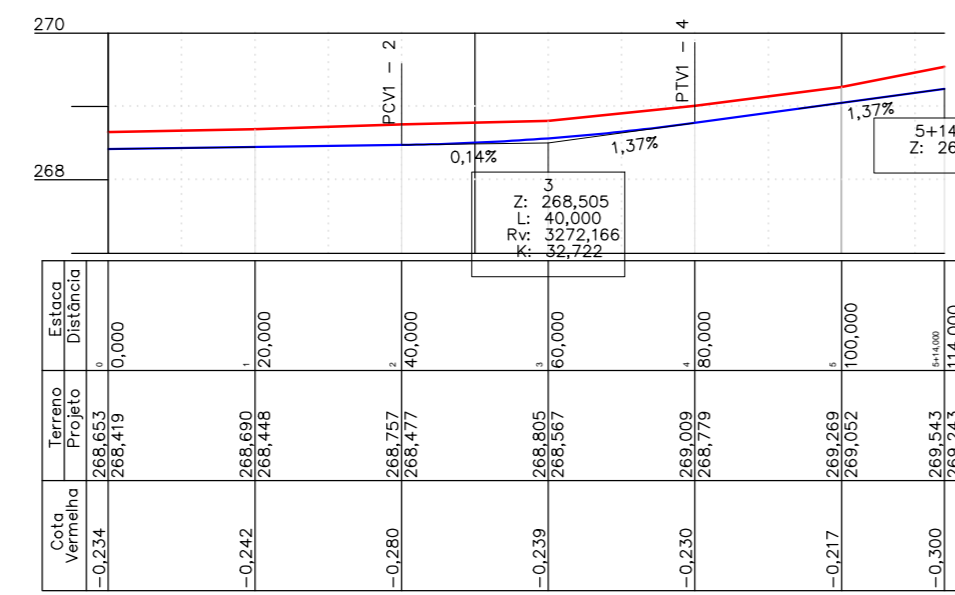

Alameda 05

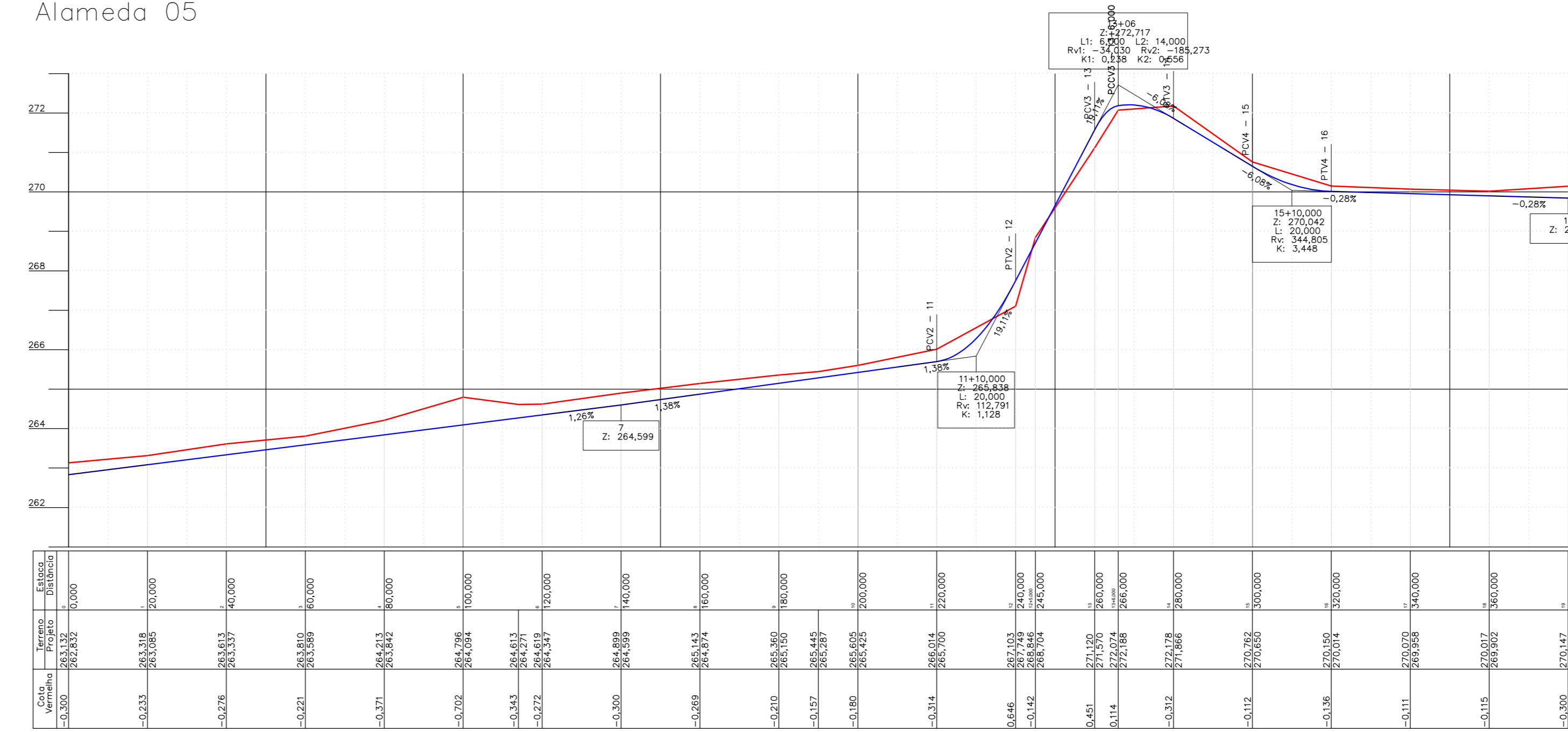

Alameda 06

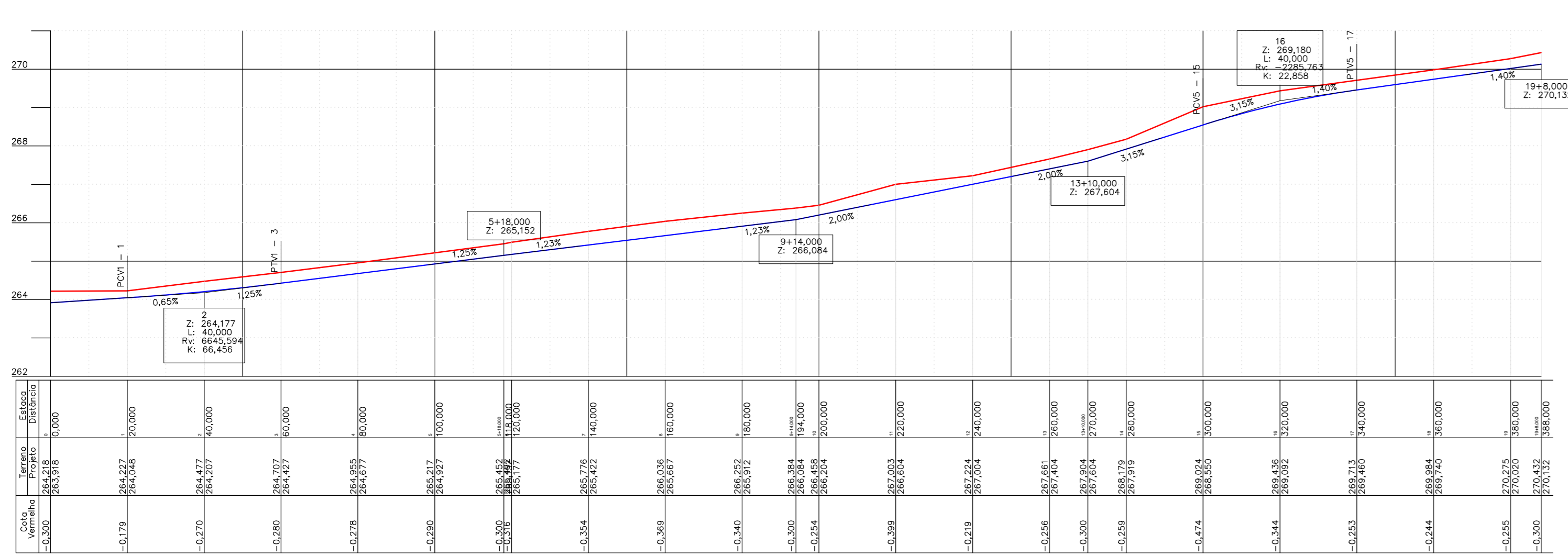

Alameda 07

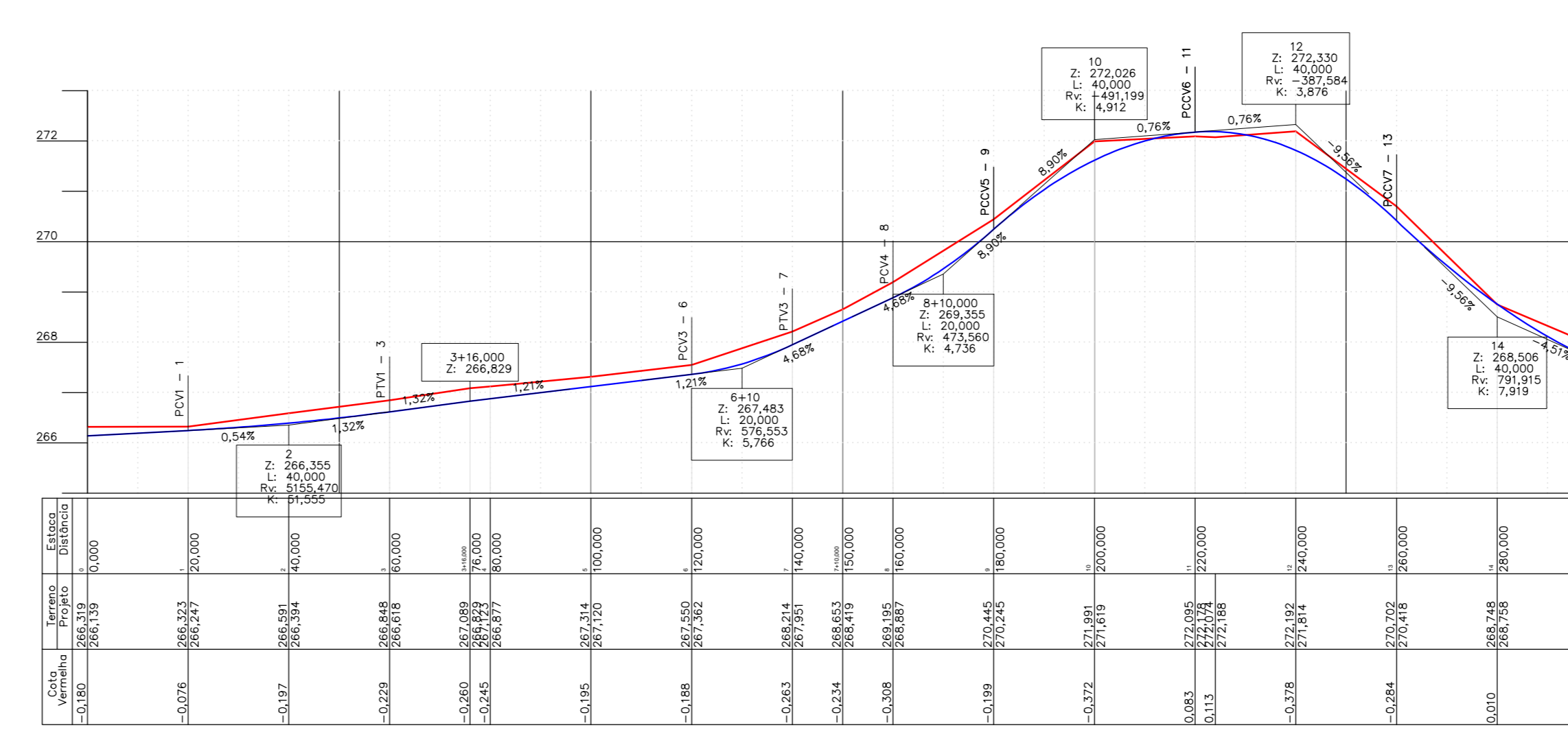

Alameda 08

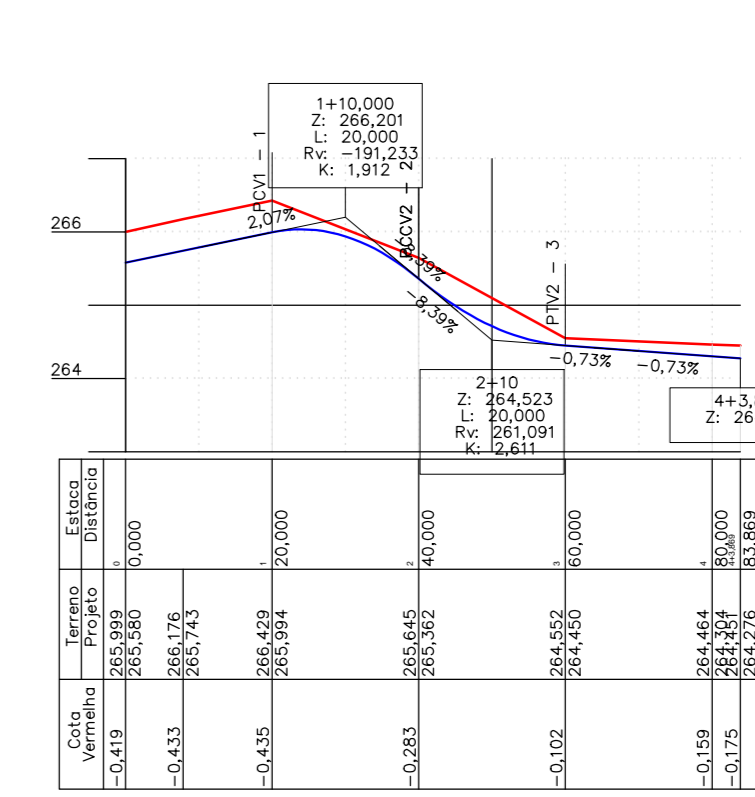

Alameda 09

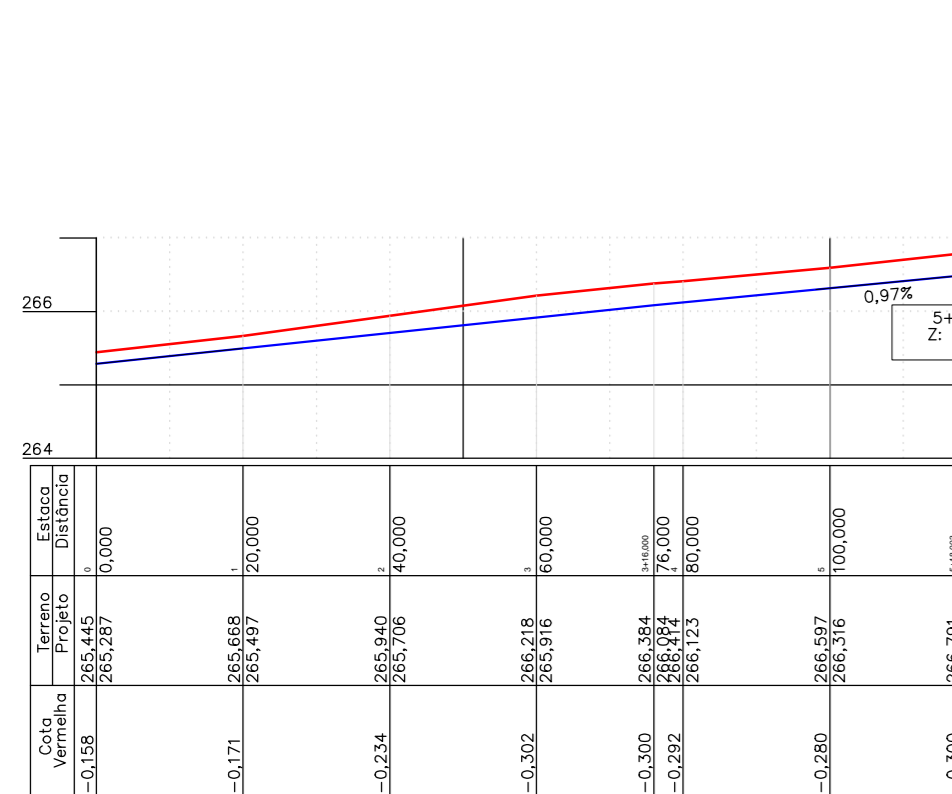

Alameda 10

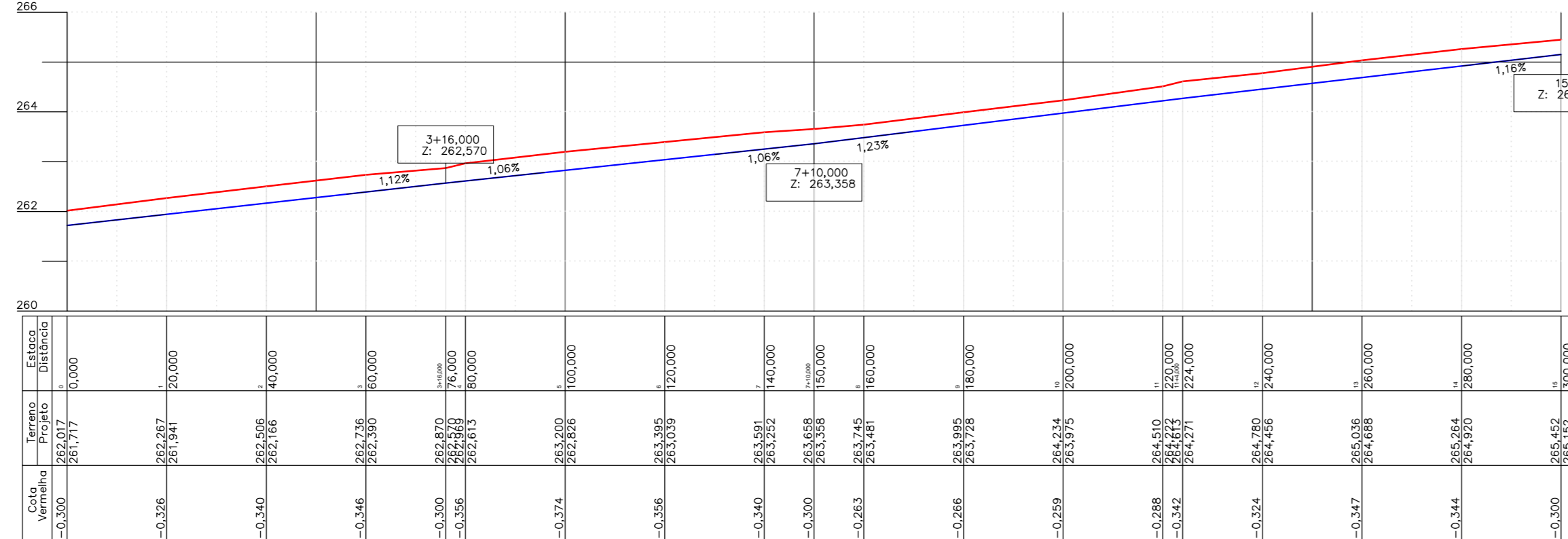

Entrada NS-08

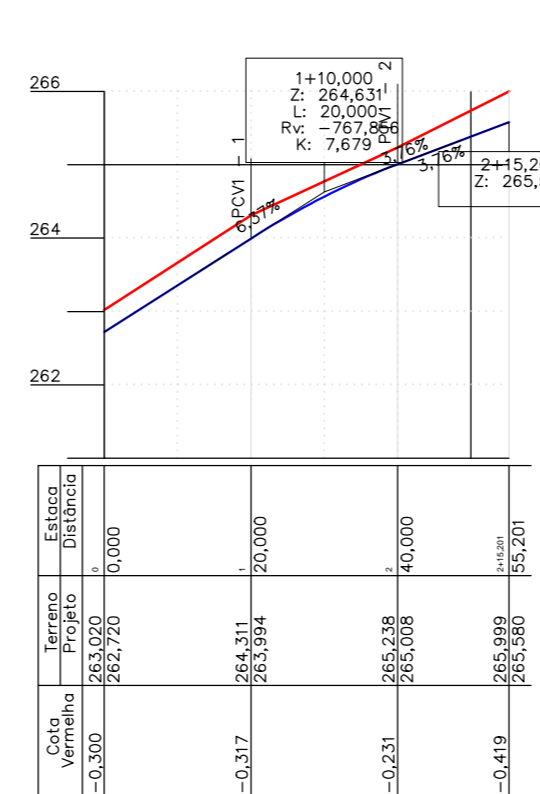

Saída NS-08

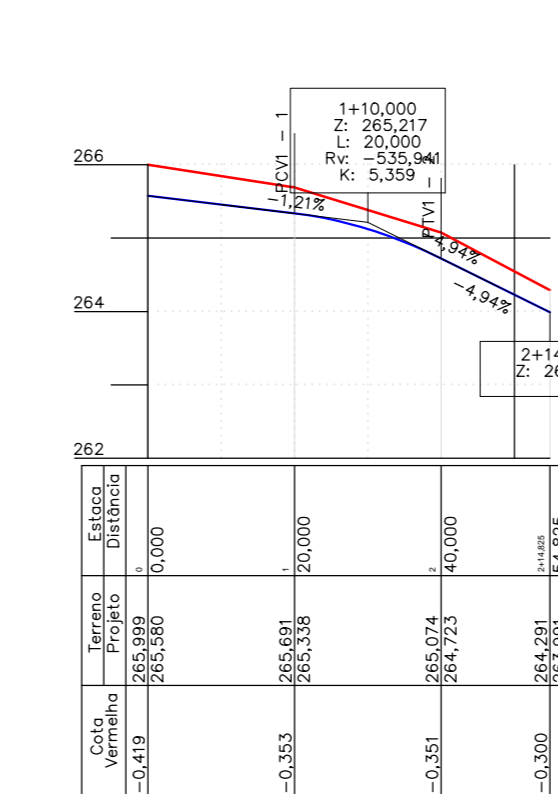

Entrada NS-10

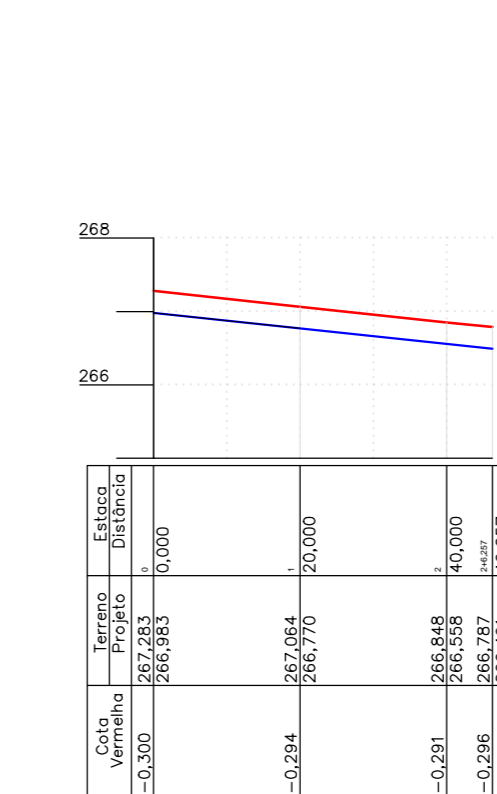

Saída NS-10

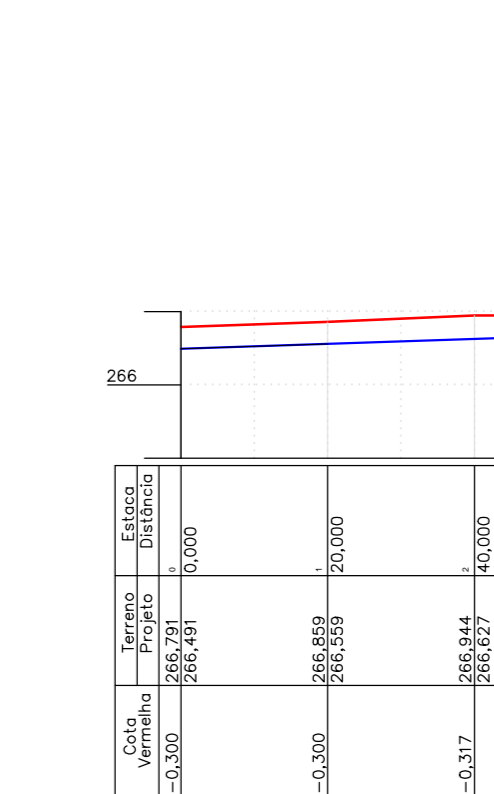

- CONVENÇÕES
- TERRENO NATURAL
 - GREDE PROJETADO

PREFEITURA MUNICIPAL DE PALMAS
SECRETARIA DE INFRAESTRUTURA E SERVIÇOS PÚBLICOS

CONVENIO	
PROJETO DE TERRAPLANAGEM	
PARCELA 01	DATA: MARÇO/2019
QUADRA 408 NORTE (ARNE 54), PALMAS-TO	REVISÃO: MARÇO/2019
CONTEUDO: PERIS LONGITUDINAIS	ESCALA: 1:1000 - VER. 1/100
RESPONSÁVEL TÉCNICO: ROBERTO LEMOS MUNIZ - END. CIVIL	DATA DE ELABORAÇÃO: MARÇO/2019
GEOSISTEMAS Engenharia & Planejamento	
Rua Ricardo Salazar, 83, Prado, Recife-PE. CEP 50.720-120 Fone/Fax: (0**81) 3878-5555. e-mail: geosistemas@geosistemas.com.br C.N.P.J.: 70.073.275/0001-30	